

Clip on Guard

Safety / Security Guard

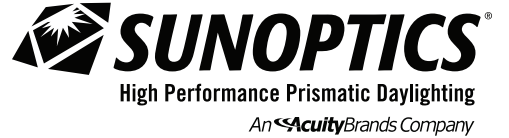

Model CLPOG

KEY FEATURES

Designed for new and retrofit applications, for both metal and wood curbs.
 Curb top design provides lifetime OSHA compliant fall protection with or without a dome.
 OSHA 1910.23(e)(8) Compliant Fall Protection Device.

PRODUCT PROFILE

Details Not To Scale

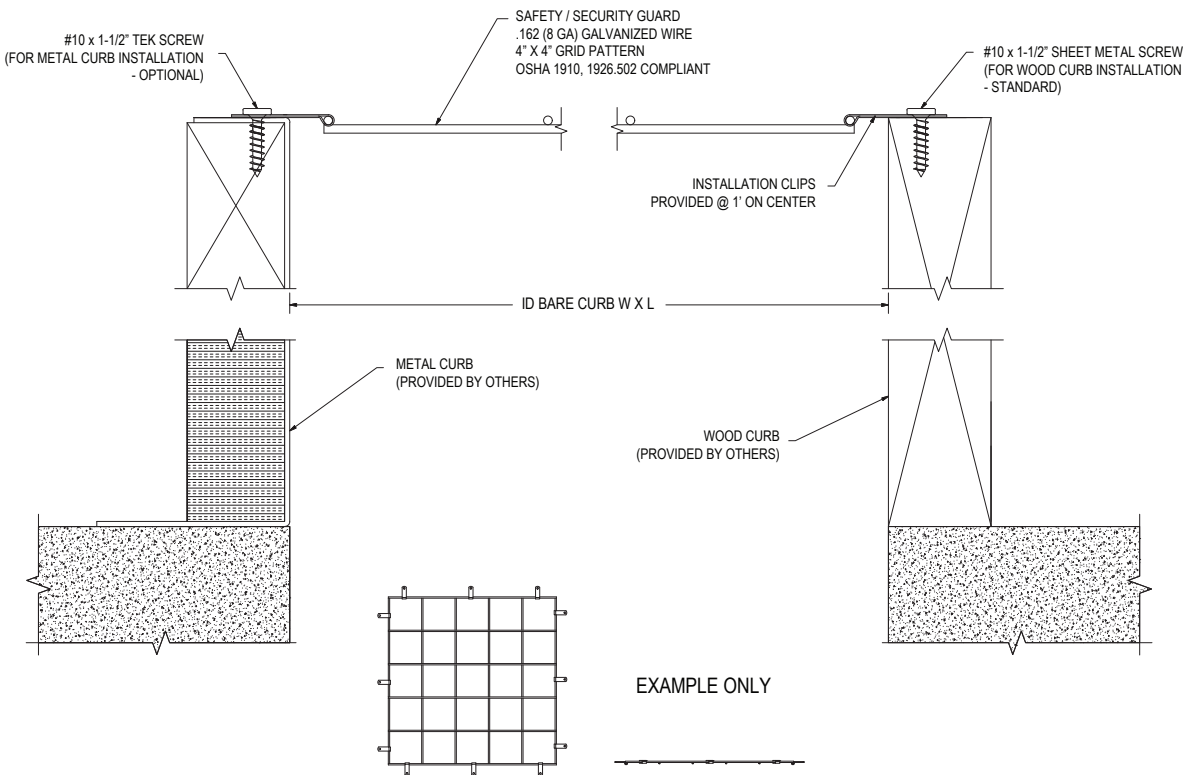

SPECIFICATIONS

Safety / Security Guard shall be Sunoptics model **CLPOG** as manufactured by Sunoptics Skylights, an Acuity Brands Company, 6201 27th Street, Sacramento CA 95822 916/395-4700.

CLPOG (Clip on Guard) shall be fabricated from 8 gauge (.162" diameter) galvanized cold roll steel, 4" maximum on center in both directions, having a 75,000 PSI tensile strength. **(Meets OSHA 1910.23(e)(8))**

CLPOG (Clip on Guard) are provided with the necessary installation clips.

OTHER GUARD STYLES (see Ordering Logic):

- "Z" Frame Guards shall be fabricated from 8 gauge (.162" diameter) galvanized cold roll steel, 4" maximum on center in both directions, having a 75,000 PSI tensile strength.
- Burglar Bars shall be fabricated from 1/2" diameter rod, 8" maximum on center in both directions.

All Safety / Security Guards shall be ready for installation and shall include #10 x 1-1/2" SMS, sheet metal screws. TEK screws are available for Metal Curb installations.

Note: Specifications subject to change without notice.

Fixture	ID Bare Curb Callout	ID Bare Curb Width	ID Bare Curb Length	Guard Type
GUARD Safety/Security Guard	2020 23" x 23" / 584mm x 584mm	W23 23" (584 mm)	L23 23" (584 mm)	CLPOG Clip on Guard ZFRM "Z" Frame Guard BURGB Burglar Bar
	2040 23" x 47" / 584mm x 1194mm	W23 23" (584 mm)	L47 47" (1194 mm)	
	2080 23" x 95" / 584mm x 2413mm	W23 23" (584 mm)	L95 95" (2413 mm)	
	20100 23" x 119" / 584mm x 3023mm	W23 23" (584 mm)	L119 119" (3023 mm)	
	3030 35" x 35" / 889mm x 889mm	W35 35" (889 mm)	L35 35" (889 mm)	
	3050 35" x 59" / 889mm x 1499mm	W35 35" (889 mm)	L59 59" (1499 mm)	
	3060 35" x 71" / 889mm x 1803mm	W35 35" (889 mm)	L71 71" (1803 mm)	
	3080 35" x 95" / 889mm x 2413mm	W35 35" (889 mm)	L95 95" (2413 mm)	
	30100 35" x 119" / 889mm x 3023mm	W35 35" (889 mm)	L119 119" (3023 mm)	
	4040 47" x 47" / 1194mm x 1194mm	W47 47" (1194 mm)	L47 47" (1194 mm)	
	4050 47" x 59" / 1194mm x 1499mm	W47 47" (1194 mm)	L59 59" (1499 mm)	
	4060 47" x 71" / 1194mm x 1803mm	W47 47" (1194 mm)	L71 71" (1803 mm)	
	4070 47" x 83" / 1194mm x 2108mm	W47 47" (1194 mm)	L83 83" (2108 mm)	
	4080 48" x 96" / 1219mm x 2438mm	W48 48" (1219 mm)	L96 96" (2438 mm)	
	40100 48" x 119" / 1219mm x 3023mm	W48 48" (1219 mm)	L119 119" (3023 mm)	
	5050 59" x 59" / 1499mm x 1499mm	W59 59" (1499 mm)	L59 59" (1499 mm)	
	5060 59-3/8" x 71-3/8" / 1508mm x 1813mm	W59.375 59-3/8" (1508 mm)	L71.375 71-3/8" (1813 mm)	
	5070 59" x 83" / 1499mm x 2108mm	W59 59" (1499 mm)	L83 83" (2108 mm)	
	5080 59" x 95" / 1499mm x 2413mm	W59 59" (1499 mm)	L95 95" (2413 mm)	
	50100 59" x 119" / 1499mm x 3023mm	W59 59" (1499 mm)	L119 119" (3023 mm)	

Use **CUST** for Custom sized units.

W . . . Custom Width

L . . . Custom Width



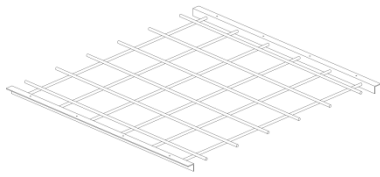

BURGLAR BAR

Safety / Security Guard



Model BURGB

KEY FEATURES

Designed for new and retrofit applications, for both metal and wood curbs.

AVAILABLE CERTIFICATIONS

PRODUCT PROFILE

DETAILS ARE NOT TO SCALE

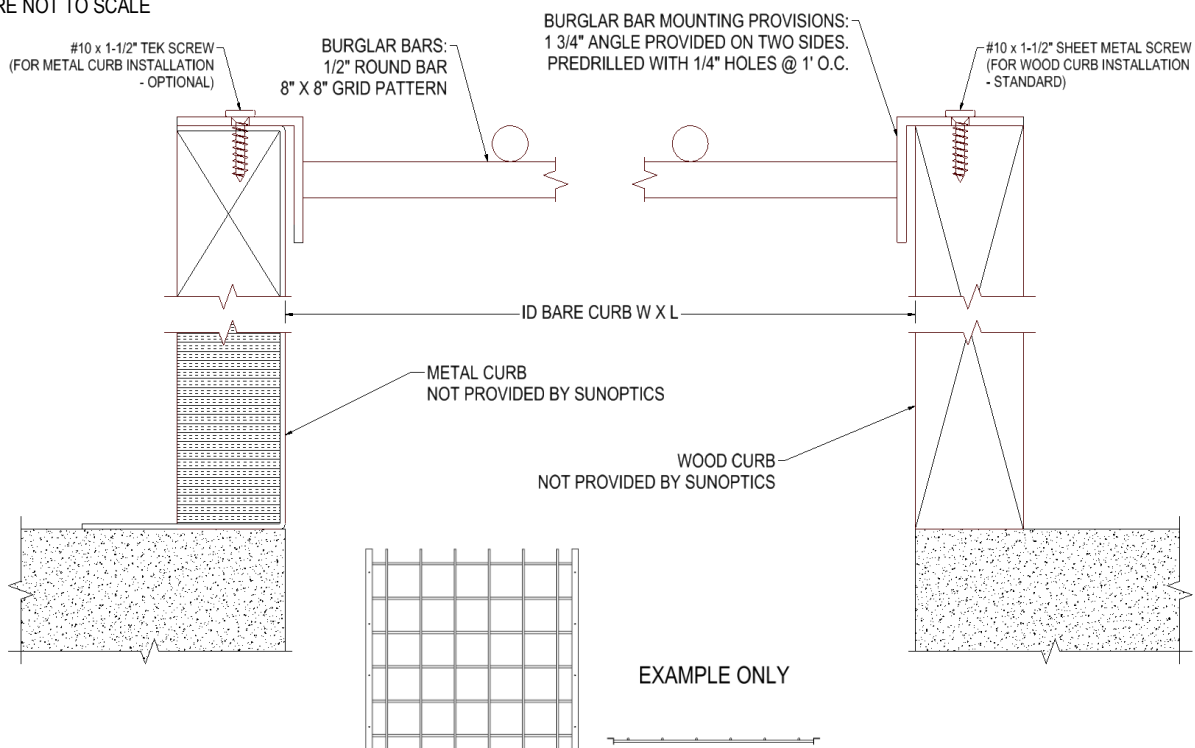

SPECIFICATIONS

Safety / Security Guards shall be Sunoptics model **BURGB** as manufactured by Sunoptics, an Acuity Brands Company, 6201 27th Street, Sacramento Ca. 95822 916/395-4700

All Safety / Security Guards shall be ready for installation and shall include #10 x 1-1/2" SMS, sheet metal screws. TEK screws are available for Metal Curb installations.

BURGB (Burglar Bars) shall be fabricated from 1/2" diameter rod, 8" maximum on center in both directions.

Note: Specifications subject to change without notice.

OTHER GUARD STYLES (see Ordering Logic):

- Clip on Guards shall be fabricated from 8 gauge (.162" diameter) galvanized cold roll steel, 4" maximum on center in both directions, having a 75,000 PSI tensile strength.
- "Z" Frame Guards shall be fabricated from 8 gauge (.162" diameter) galvanized cold roll steel, 4" maximum on center in both directions, having a 75,000 PSI tensile strength.

ORDERING LOGIC

Fixture		ID Bare Curb Callout		ID Bare Curb Width		ID Bare Curb Length		Guard Type	
GUARD	Safety/Security Guard	2020	23" x 23"	W23	Width 23 inches	L23	Length 23 inches	CLPOG	Clip on Guard
		2040	23" x 47"	W23	Width 23 inches	L47	Length 47 inches	ZFRM	"Z" Frame Guard
		2080	23" x 95"	W23	Width 23 inches	L95	Length 95 inches	BURGB	Burglar Bar
		20100	23" x 119"	W23	Width 23 inches	L119	Length 119 inches		
		3030	35" x 35"	W35	Width 35 inches	L35	Length 35 inches		
		3050	35" x 59"	W35	Width 35 inches	L59	Length 59 inches		
		3060	35" x 71"	W35	Width 35 inches	L71	Length 71 inches		
		3080	35" x 95"	W35	Width 35 inches	L95	Length 95 inches		
		30100	35" x 119"	W35	Width 35 inches	L119	Length 119 inches		
		4040	47" x 47"	W47	Width 47 inches	L47	Length 47 inches		
		4050	47" x 59"	W47	Width 47 inches	L59	Length 59 inches		
		4060	47" x 71"	W47	Width 47 inches	L71	Length 71 inches		
		4070	47" x 83"	W47	Width 47 inches	L83	Length 83 inches		
		4080	48" x 96"	W48	Width 48 inches	L96	Length 96 inches		
		40100	48" x 119"	W48	Width 48 inches	L119	Length 119 inches		
		5050	59" x 59"	W59	Width 59 inches	L59	Length 59 inches		
		5060	59-3/8" x 71-3/8"	W59.375	Width 59.375 inches	L71.375	Length 71.375 inches		
		5070	59" x 83"	W59	Width 59 inches	L83	Length 83 inches		
		5080	59" x 95"	W59	Width 59 inches	L95	Length 95 inches		
		50100	59" x 119"	W59	Width 59 inches	L119	Length 119 inches		
	Use CUST for Custom Sized Units	W_	Custom Width	L_	Custom Length				