

Sunoptics LightFlex™

For Suspended-Ceiling Applications

21" (533mm) Diameter Tubular Daylighting System

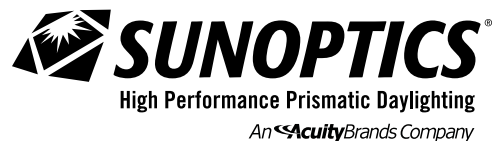

LightFlex™ Tubular System SLFT

KEY FEATURES

Prismatic Optic Sphere for Increased Daylight Conveyance

98% Reflective MIRO-SILVER® Interior Light Well with Greater than 99% Specular Quality

Adjustable Elbows to Bypass Obstructions

Acuity Brands Luminaire Diffuser Options to Complement your Lighting Design

Signature Series skylight to capture more light in the early morning and late afternoon

Optional Warm-White Color Shifting Lens Insert to Complement your Lighting Design

Optional single-blade louver to turn on or shut off daylight entering the space (i.e. light levels for AV)

Warranty: 10 year and 15 year limited warranty available. Complete warranty terms located at: www.acuitybrands.com/CustomerResources/Terms_and_conditions.aspx

Note: Actual performance may differ as a result of end-user environment and application.

Specifications subject to change without notice.

AVAILABLE SKYLIGHT CERTIFICATIONS

CE Approved (CC2__ or CC1)

ICC-ES (CC2__ or CC1)

HVHZ Approved (CC1CC2)

FM Approved (CC1)

AAMA Certified (CC2__ or CC1)

NFRC Certified (CC2__ or CC1)

Skylight Hail Class Rating

Material Type	Lens Material	Resistance Rating	Hail Size
Acrylic	CC2CL1	Class 1	1-1/4"
Acrylic	CC2CL3	Class 3	1-3/4"
Polycarbonate over Acrylic	CC1CC2	Class 4	2"
Polycarbonate	CC1	Class 4	2"

DIFFUSER/LENS OPTIONS



TLED Micropism Lens

ACLED Lens

ALLED Lens

TLED Shadowbox Lens

TLED Satin Lens

SPECIFICATIONS

LightFlex shall be Sunoptics model 800SLFT as manufactured by Sunoptics, an Acuity Brands Company, 6201 27th Street, Sacramento Ca. 95822 916/395-4700

Signature Series Prismatic Skylight frame shall be fabricated from 6063-T5 aluminum, finish to be natural mill. Frames shall have integral condensation and weepage gutters which drain interior moisture to the outside. Corners shall be mitered and welded. The acrylic glazing shall be separated from the skylight frame with a Silicon Seal.

The integral curb shall be fabricated from .063" sheet aluminum on the exterior, corners heli-arc welded, and include a rigid insulation. The 21" (533mm) diameter light well and adjustable elbows shall be fabricated from 98% reflective MIRO-SILVER® with greater than 99% specular quality.

Round to square transition fabricated from 98% reflective MIRO-SILVER® with greater than 99% specular quality with integrated diffuser door frame. Multiple lens options available with differentiating luminous patterns and designs.

CONTROLS: The LightFlex daylighting system is available both nLight®-networked or 110VAC Single Pole/Double Throw Momentary Switch for on/off manual control, allowing integration of daylight and electric lighting.

Certain airborne contaminants can diminish the integrity of acrylic and/or polycarbonate lenses. Refer to the compatibility tables for suitable uses on our website.

Skylights not for use in Harsh, Corrosive, Marine and high-humidity Environmental Conditions such as Marina, Greenhouses, Petrol-Chemical facilities or other chemicals where the skylights may be exposed to such conditions.

Warm-white color-shifting lens is available as an option to shift daylight temperature to between 3600-3700k depending on the time of day.

Cleaning Acrylic Lenses: Frequency of cleaning is determined by site conditions. When cleaning acrylic lenses, use only water or water with a mild soap. Use a soft rag to minimize scratching the acrylic. A pressure washer is acceptable to use as well. Never use ammonia, aromatic or petroleum based products to clean acrylic lenses. This will cause deterioration and cracking of the lens and will void the warranty.

Skylights should not be installed in locations with an operating temperature in excess of -75° F or 180°F.

PRODUCT PROFILE

Details Not To Scale

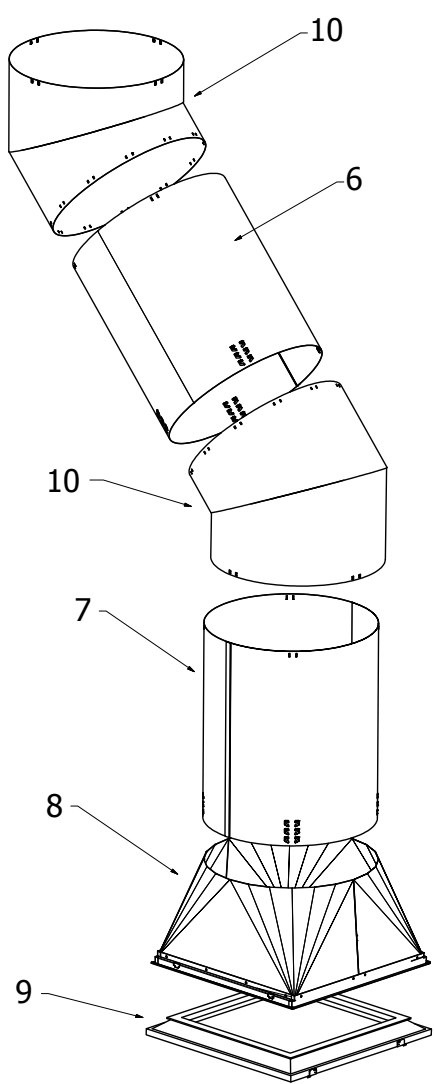
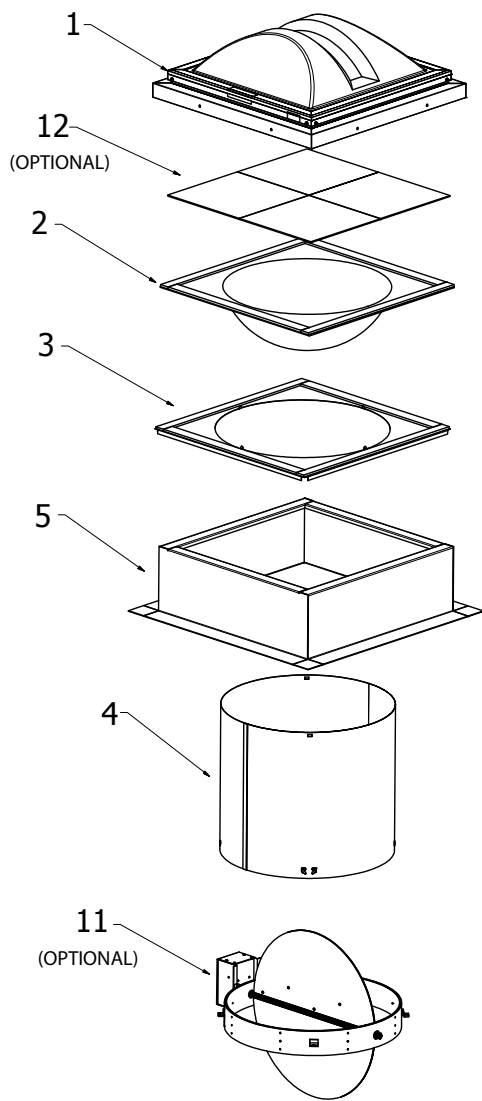

Roof Curb	Required Curb Dimensions
Outside Dimensions	25" (635mm) x 25" (635mm)
Inside Dimensions	22" (559mm) x 22" (559mm)

Item	Description
STANDARD KIT ITEMS (Items 1 - 10)	
1	Nominal 2020 Signature Series Skylight
2	Optic Sphere
3	Curb Transition
4	18" (406mm) Roof Curb Top Tube
5	Curb
6	24" (610mm) Light Well Tube #1*
7	24" (610mm) Light Well Tube #2*
8	Round-To-Square Transition
9	Diffuser
10	Adjustable 0-45° Angle Tube
OPTIONAL ITEMS (Non-Standard Kit Items. Please specify in order logic.)	
11	Single-Blade Louver
12	LightFlex CCT
*Quantity of tube sections is determined by curb to suspended ceiling distance. (See page 2)	
CAUTION: Handle Reflective Material with Care.	

Optional Damper Wiring Diagrams

nLight Networked Controls

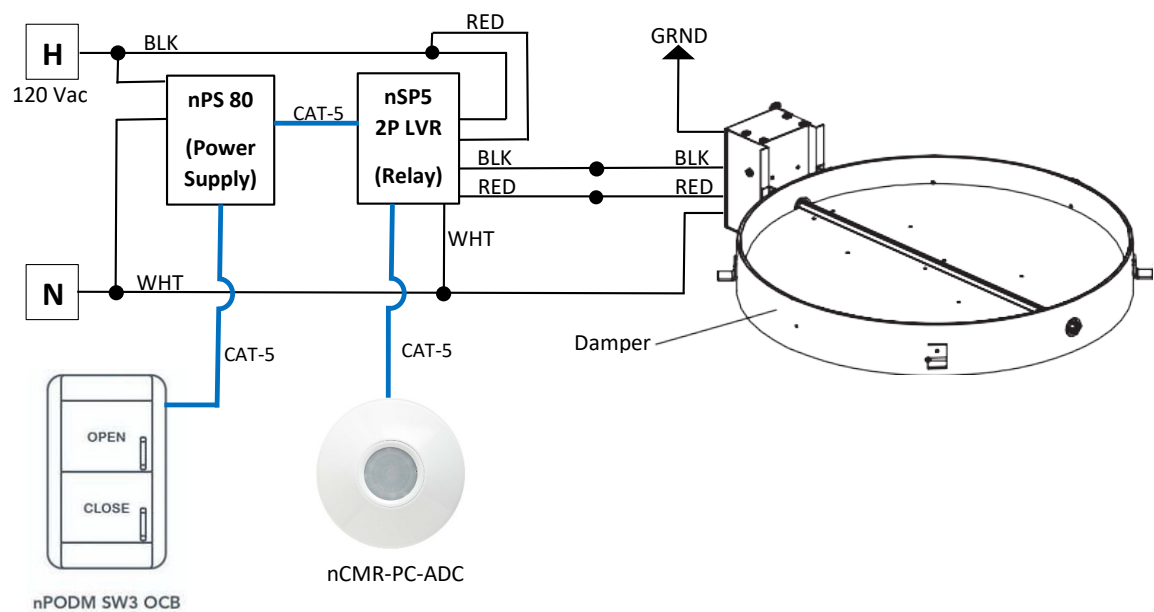

Single Pole Double Throw (SPDT) Switch Option

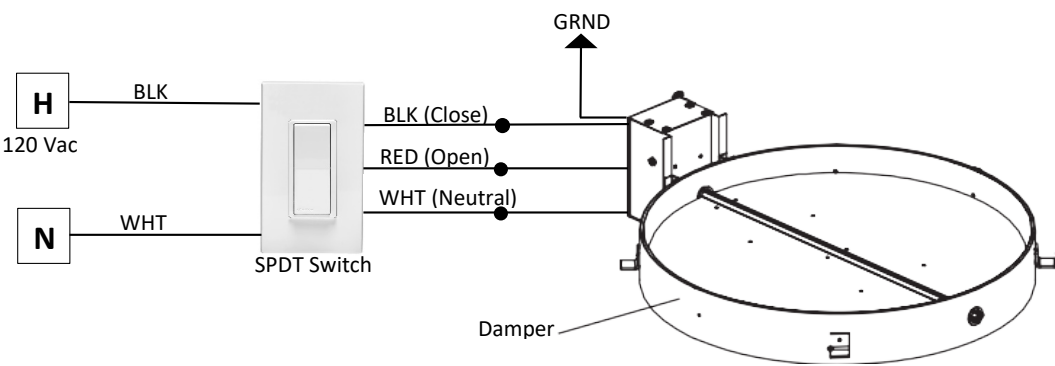

ORDERING LOGIC

LightFlex™ Tubular System SLFT

Lead times will vary depending on options selected. Consult with your sales representative.

Example: SLFT 2108 SGZ CC1 ALLED 4FT

Fixture	Curb Height	Skylight Glazing	Skylight Lens Material
SLFT LightFlex Tubular System	2108 8 inch (203mm) (Default)	SGZ Single Glaze	CC1CC2 Polycarbonate
	2114 14 inch (356mm)	DGZ Double Glaze	CC1 Polycarbonate
			CC2CL1 Acrylic Class 1 (Default)
			CC2CL3 Acrylic Class 3

Diffuser Lens Style	Light Wall Length	Options
TLSBOX TLED Shadowbox Lens Assembly	4FT 4-Foot (1219mm) Shaft - Max tube Length 60"	DAMPER Light Louver
TLMICPRIS TLED Micropism Lens Assembly	6FT 6-Foot (1829mm) Shaft - Max tube Length 82"	ELBOWS2 Additional set of Elbows for 90 degree Turns
TLSATIN TLED Satin Lens Assembly	8FT 8-Foot (2438mm) Shaft - Max tube Length 104"	SUSKIT Suspension Wire Kit
ACL ACLED Troffer Lens Assembly	10FT 10-Foot (3048mm) Shaft - Max tube Length 126"	DWGA* Dry-Wall Grid Adaptor
METRIC 600mm x 600mm Ceiling Grid Pattern	12FT 12-Foot (3658mm) Shaft - Max tube Length 148"	SBAR Security Bar
ALLED ALLED Troffer	14FT 14-Foot (4267mm) Shaft - Max tube Length 170"	CCT Warm-white color-shifting lens
MG2WHFL Magellan White Flat Round Lens ¹	16FT 16-Foot (4877mm) Shaft - Max tube Length 192"	
MG2WHPR Magellan White Prismatic Round Lens ¹	18FT 18-Foot (5486mm) Shaft - Max tube Length 214"	

Note:

- The Diffuser Lens Styles mentioned above are only available for the SLFT model.
- For other Diffuser lens styles, please contact your Sunoptics Representative.
- 2 (0-45) elbows included.
- If the determined length falls between shaft lengths, select the longer length available.
- Additional tubes may be required when avoiding obstructions.
- For lengths over 18ft, please contact your local Sunoptics Representative.
- Max length is total tube length (allowing for 2" overlap) using 24" lengths.

* Only available with Magellan Lens options
 1 - For Dry Wall/Hard ceiling applications only.

LightFlex (SLFT) Louver control options. One each per zone

*212CJ8	nSP5 2P LVR - Skylight Louver Control Pack
*262P7U	nPODM SW3 OCB WH - Louver Control
*222J7X	nCMR ADC LVR – Photocell (not required if automatic daylight control not required)
	or (for manual operation)
Outsourced	Single Pole Double Throw Momentary Switch



SLFT_Tubular