

Multi-Lite Fixed Skylights

Double Hip, Pyramid & Signature**



MLT | Frame Model 800SB

PRODUCT PROFILE



Details Not To Scale

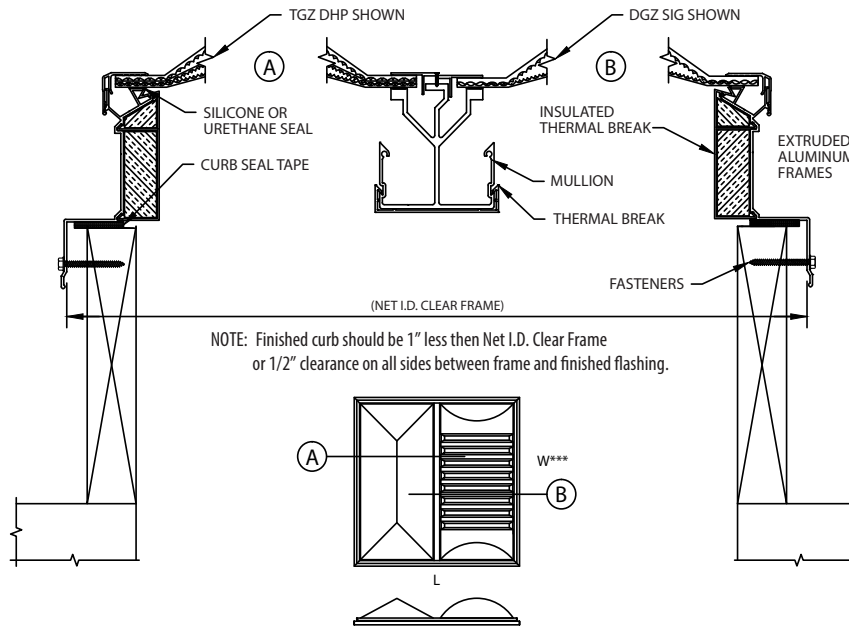

SPECIFICATIONS

Skylights shall be Sunoptics model 800SB Multi-Lite (curb mounted) as manufactured by Sunoptics Skylights, 6201 27th Street, Sacramento Ca. 95822 916/395-4700

Skylights shall be glazed ready for installation.

Skylights frames shall be fabricated from 6063 T6 aluminum, finish to be specified. Frames shall have integral condensation and weepage gutters which drain interior moisture to the outside. Corners shall be mitered and welded. The acrylic glazing shall be separated from the skylight frame with an EPDM rubber air seal gasket.

Individual lights shall be joined by an aluminum extruded mullion integral to the skylight frame, quantity as required for skylight size.

Note: Multi-glazed units default to include Insulated Thermal Break (ITBR), CTape, Weather Sweep (WSW) and screws. Single-glazed units default to not included any of these options.

Formed Skylights shall be Double glazed or Signature using 50% Impact Modified Clear prismatic outer lens over White prismatic inner lens, or Triple glazed using 50% Impact Modified Clear prismatic outer lens over White prismatic middle lens over Clear prismatic lower lens.

Double Hip and Signature units are tested and certified to AAMA/WDMA/CSA101/I.S.2/A440-05 to comply with section 2405.5 of the International Building Code.

Certain airborne contaminants can diminish the integrity of acrylic and/or polycarbonate lenses. Refer to the compatibility tables for suitable uses on our website.

Skylights not for use in Harsh, Corrosive, Marine and high-humidity Environmental Conditions such as Marina, Greenhouses, Petrol-Chemical facilities or other chemicals where the skylights may be exposed to such conditions.

Double Hip or Pyramid Hail Class Rating

Material Type	Lens Material	Resistance Rating	Hail Size
Acrylic	50CC2	Class 1	1-1/4"
Acrylic	CC2CL3	Class 3 (incl. Class 1)	1-3/4"
Polycarbonate	CC1	Class 4	2"

Skylight Thermal Performance

Type	SHGC	U-Value	VLT
Single Glazed Acrylic CC2CL3	.51	n/a	.74
Double Glazed Clear/White	.42	.70	.68
Doubled Glazed White/White	.31	.70	.65
Triple Glaze White/White/Clear	.26	.57	.64

Cleaning Acrylic Lenses: Frequency of cleaning is determined by site conditions. When cleaning acrylic lenses, use only water or water with a mild soap. Use a soft rag to minimize scratching the acrylic. A pressure washer is acceptable to use as well. Never use ammonia, aromatic or petroleum based products to clean acrylic lenses. This will cause deterioration and cracking of the lens and will void the warranty. Skylights should not be installed in locations with an operating temperature in excess of -75° F or 180°F.

Buy American: This product is assembled in the USA and meets the Buy America(n) government procurement requirements under FAR, DFARS and DOT. Please refer to www.acuitybrands.com/resources/buy-american for additional information.

Warranty: 5-year and 10-year limited warranty available. Complete warranty terms located at: www.acuitybrands.com/support/warranty/terms-and-conditions

Note: Actual performance may differ as a result of end-user environment and application.

Specifications subject to change without notice.

** Mold Fee May Apply

*** Mullions are in Width Direction

ORDERING LOGIC

Multi-Light Fixed Skylights

					▶▶
--	--	--	--	--	----

Fixture	ID Frame Call-Out	Lens Shape	Glazing	Lens Material
MLT Multi-Lite	Use CUST for Custom sized units.	SIGL Signature Series* DHPL Double Hip Series	SGZ Single Glaze DGZ Double Glaze TGZ Triple Glaze	CC1CC2 Polycarbonate CC1 Polycarbonate 50CC2 50% IM Acrylic** CC2CL3 Acrylic Class 3

--	--	--	--

Lens Color	Unit Type	Skylight Frame Finish	Options
LENSWH White (Single Glaze Default) ¹	800SB Standard Frame	MI Mill (Default)	(blank) No Options
LENSCL Clear ¹		WH White	ITBR Insulated thermal break
LENSWHCL White Clear ²		BZ Bronze	NITBR No Insulated Thermal Break
LENSCLWH Clear White (Double Glaze Default) ²		CF Custom Color	
LENSWHWH White White ²			
LENSCLCL Clear Clear ²			
LENSWHWHWH White White White ³			
LENSCLCLCL Clear Clear Clear ³			
LENSCLWHCL Clear White Clear (Triple Glaze Default) ³			
LENSWHCLWH White Clear White ³			
LENSCLWHWH Clear White White ³			
LENSWHCLCL White Clear Clear ³			

* mold fee may apply ** available with Double Hip only 1) Single Glaze 2) Double Glaze 3) Triple Glaze



800SB_Multilite_DHPS